

1-1/4" SOLENOID VALVE

VALVE MODEL SPECIFICATIONS

Materials of Construction

Body: Brass
Armature Tube: Stainless Steel 300
Fixed Core: Stainless Steel 400
Plunger: Stainless Steel 400
Spring: Stainless Steel 300
Shading Ring: Copper
Orifice: Brass
Pipe Threading: NPT

Electrical Connection

Rating: NEMA 4
Inrush VA: 25.0
Holding VA: 14.5
Connector: Cable grip DIN

ADDITIONAL VALVE INFORMATION

Solenoid Valve Dimensions

Valve Width (A): 3 7/8"
Valve Length (B): 5 21/32"
Valve Height (C): 4 15/16"
Coil Width (D): 1 3/16"
Coil Length (E): 1 21/32"
Coil Length (F): 2 1/8"

Spare Parts

Armature Tube: AT-A001
Repair Kit: RK-W004

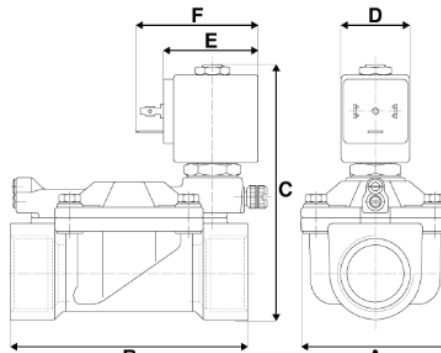

SOLENOID VALVE DETAILS

Valve Model #W7B19-000-02

Pipe Size: 1 1/4"
Orifice Size: 1 3/8"
Flow Factor: 28.00 Cv
Power: 8 watts
Minimum Operating Pressure: 2 psi
Maximum Operating Pressure: 150 psi
Voltage/Current: 120 V AC

Valve Sealing Material

Sealing Material: NBR
Temperature: 14-195°F
Medium Examples: Air, Inert gas, Water

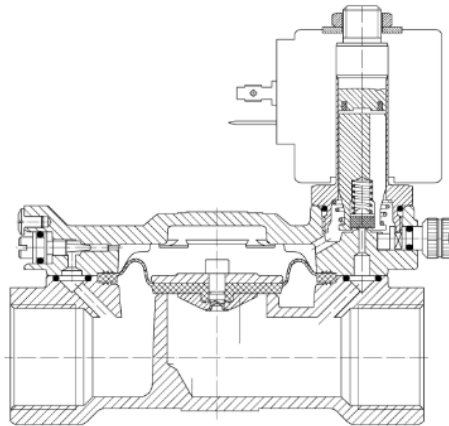

VALVE MODEL SPECIFICATIONS

Materials of Construction

Body: Brass
Armature Tube: Stainless Steel 300
Fixed Core: Stainless Steel 400
Plunger: Stainless Steel 400
Spring: Stainless Steel 300
Shading Ring: Copper
Orifice: Brass
Pipe Threading: NPT

Electrical Connection

Rating: NEMA 4
Inrush VA: 25.0
Holding VA: 14.5
Connector: Cable grip DIN